

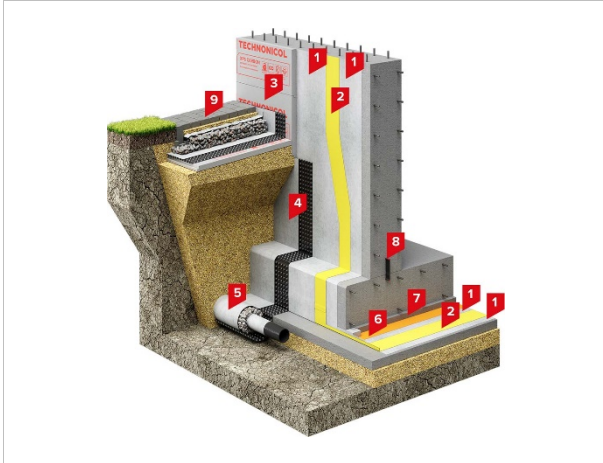

TN FOUNDATION PVC PROTECT BARRIER

Waterproofing solution for a foundation with PVC membrane and drainage



Area of application

The system is designed for underground waterproofing of buildings and structures erected in pits with backfilling, in predominantly sandy soils, without the constant presence of groundwater above the level of the foundation slab.

Advantages



Quick installation



Signal layer for easy quality control



Loose laid system



Efficient removal of groundwater

System composition and material consumption rates

No.	Material	Unit	Thickness, mm*	Consumption rate**
1	Needle-punched geotextile	m ²	2.3 × 2	1.15 × 2
2	LOGICBASE V-SL	m ²	2.0	1.15
3	XPS TECHNOMICOL CARBON PROF 300 (optional)	m ³	50-200, increments 10 mm	1.03
4	PLANTER geo	m ²	8	1.15
5	Drainage pipe	–	–	acc. to calculation
6	Polyethylene film	m ²	0.2	1.15
7	Protective sand-cement screed	–	≥40 mm	acc. to calculation
8	TECHNONICOL IC-125-2-SP waterstop	m	–	acc. to calculation
9	Blind area	–	–	acc. to calculation

*The available thicknesses of the selected thermal insulation materials are to be checked with the manufacturer.

**The consumption rates are taken conditionally – according to the manufacturer's recommendations.

Technical description

The single-ply waterproofing system is based on a premium non-reinforced PVC membrane LOGICBASE V-SL with a special yellow signal layer for prompt and easy quality control of works. The overlaps of the loose laid membrane are welded with hot air using automatic welding equipment to form double seams with a central air channel designed to check their tightness.

Needle-punched geotextile with a surface density of 500 g/m² is used as a protective and separating layer. On the horizontal part of the foundation, additional protective layers of polyethylene film and sand-cement screed are provided.

The wall drainage system made of dimpled HDPE membrane PLANTER geo and drainage pipes effectively removes the atmospheric and ground waters from the basement walls and protects the waterproofing layer from possible damage.

In case the thermal insulation of the socle is required, one may use XPS slabs TECHNOMICOL CARBON PROF 300. To seal the concrete joints at the junctions of the slab and the foundation wall, a special TECHNOMICOL IC-125-2-SP waterstop is used.