

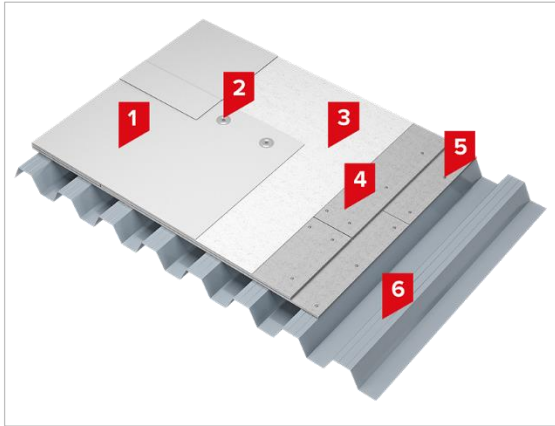

TN ROOF PVC STEEL LIGHT

Non-accessible roof system without thermal insulation on a corrugated steel sheet base with mechanical fastening of PVC membrane



APPLICATION OBJECT:

Industrial Buildings, Logistics centers, Shopping centers, Warehouses.

SPECIAL FEATURES OF THE SYSTEM:



No limit on roof surface area



High durability



High strength welds



Speeded up erection works

SYSTEM ELEMENTS:

No	Name	Unit	Thickness, mm	Consumption m ²
1	Polyester reinforced PVC membrane LOGICROOF V-RP	m ²	-	1.15
2	Plate-shaped holder, with diameter not less than 50 mm	pcs.	-	According to the project
3	Synthetic geotextile 300g/m ²	m ²	-	According to the project
4	Prefabricated screed in 2 layers	m ²	-	According to the project
5	Self-tapping screw	pcs.	-	According to the project
6	Corrugated steel sheet	m ²	-	According to the project

ALTERNATIVE MATERIALS:

4. Plywood

ASSEMBLY:

According to the "INSTALLATION MANUAL. Application of single-layer polymeric waterproofing membranes" by TECHNOMICOL Company

DOWNLOAD LINKS:



System Description