



# LOGICROOF

**SINGLE-PLY PVC SYNTHETIC MEMBRANES**

# MODERN ROOFING SOLUTIONS

Buildings of all types require a durable roof. The roof should have a long service life without substantial repair. Use of long-lasting roofing systems made of synthetic membranes is a modern solution, which combines reliability and rapid installation.

LOGICROOF PVC membranes are high-tech materials, designed for long-term waterproofing of buildings and structures. They are contemporary, reliable and durable waterproofing materials produced using co-extrusion technology – currently the best on the market.

## FEATURES



### DURABILITY

The main reason for the failure of roofing materials is ageing. LOGICROOF membranes have a 200- $\mu\text{m}$  special protective top layer with highly concentrated stabilizers, which block UV radiation that can harm the structure of the polymer.



### INSTALLATION ANYTIME

Installation can be carried out all year round regardless of the season or temperature. LOGICROOF membranes are perfectly designed and can even be welded in cold or wet conditions.



### SELF-EXTINGUISHABLE

The plastic compound used in each layer of the membrane contains different types of high-quality flame retardants and fireproof filling. This slows oxidation at high temperatures and prevents the membrane from burning when unexpectedly exposed to sources of ignition.



### VIRGIN POLYMERS ONLY

LOGICROOF PVC membranes are produced from virgin polymers. This provides the membranes with the highest stability.



### QUICK INSTALLATION

Increased roll width and length ensures the fast installation of the waterproofing membrane with fewer welds on large roofing areas.



### DURABLE PACKAGING

Every roll of LOGICROOF membrane is protected in individual UV and contamination-resistant PE packaging.

## APPROVED QUALITY

The high quality of LOGICROOF membranes is backed up by the numerous certificates it has received from organisations all over the world.



# ROOFING PVC MEMBRANES

Our materials are produced on an advanced automated line using co-extrusion method, which ensures material uniformity.

## LOGICROOF V-RP

PVC membrane reinforced with a special polyester mesh. To be installed at a temperature over -20°C.

Thickness, mm	1.2	1.5	1.8	2.0
Tensile strength L/T, N/50 mm	1100 / 900			
Elongation L/T, %	≥18			
Flexibility, °C	-35			
Volume on pallet, m <sup>2</sup>	945	756	567	567



## LOGICROOF V-RP T

PVC membrane reinforced with a special polyester mesh. T – Special skid-resisting textured surface. To be installed at a temperature over -20°C.

Thickness, mm	1.2	1.5	1.8	2.0
Tensile strength L/T, N/50 mm	1100 / 900			
Elongation L/T, %	≥18			
Flexibility, °C	-35			
Volume on pallet, m <sup>2</sup>	945	756	567	567

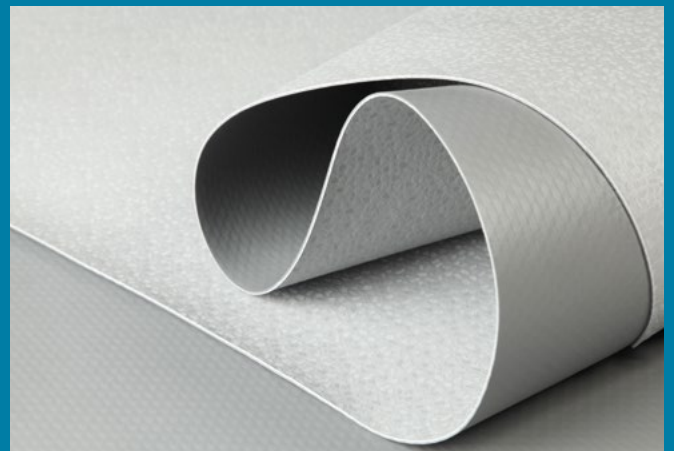

## LOGICROOF V-RP FB

PVC membrane reinforced with a special polyester mesh. Laminated geotextile fleece on the bottom surface. Designed for use in fully adhered systems. Ideal for renovation.

Thickness, mm	1.5	2.0
Tensile strength L/T, N/50 mm	1100 / 900	
Elongation L/T, %	≥18	
Flexibility, °C	-30	
Volume on pallet, m <sup>2</sup>	630	567



# PVC MEMBRANES FOR SPECIAL APPLICATION

Due to the optical quality control, we can guarantee uniform thickness of the produced membranes.

## LOGICROOF V-GR

PVC membrane reinforced with a fiberglass. Resistant to punctures and damages. Contains fungicidal additives – plant root penetration resistance.

Thickness, mm	1.5	1.8	2.0	2.4
Tensile strength L/T, N/50 mm	800 / 600			
Elongation L/T, %	≥200			
Flexibility, °C	-30			
Volume on pallet, m <sup>2</sup>	738	553.5		

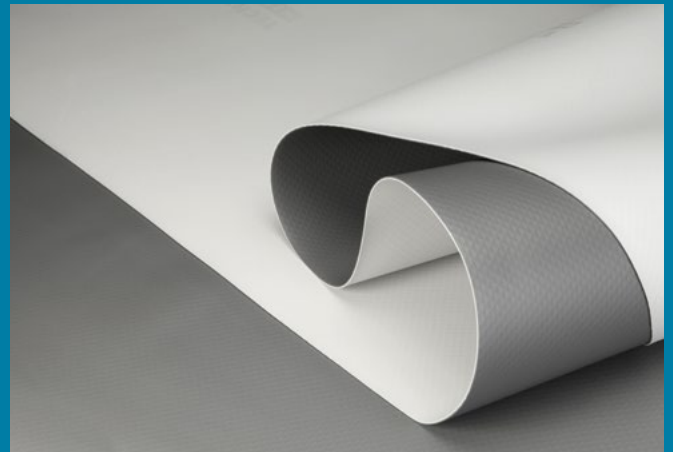

## LOGICROOF V-GR FB

PVC membrane reinforced with a fiberglass. Laminated geotextile fleece on the bottom surface. Designed for use in fully adhered systems. Ideal for renovation.

Thickness, mm	1.5	1.8	2.0	2.4
Tensile strength L/T, N/50 mm	800 / 600			
Elongation L/T, %	≥200			
Flexibility, °C	-30			
Volume on pallet, m <sup>2</sup>	553.5			

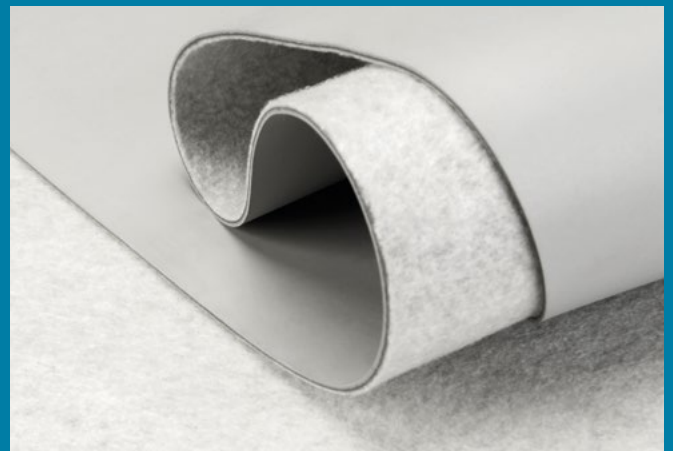

## LOGICROOF V-SR

PVC membrane without reinforcement (with high elasticity). It is used for reinforcing and linking of different parts in various roof structures such as pipes and funnels.

Thickness, mm	1.5	2.0
Tensile strength L/T, Mpa	16 / 15	
Elongation L/T, %	≥200	
Flexibility, °C	-30	
Volume on pallet, m <sup>2</sup>	420	600



# ROOFING SYSTEMS LOGICROOF

Design of reliable roofing system is based on three main principles: components integrity, substrate or structure durability and careful elaboration of details.

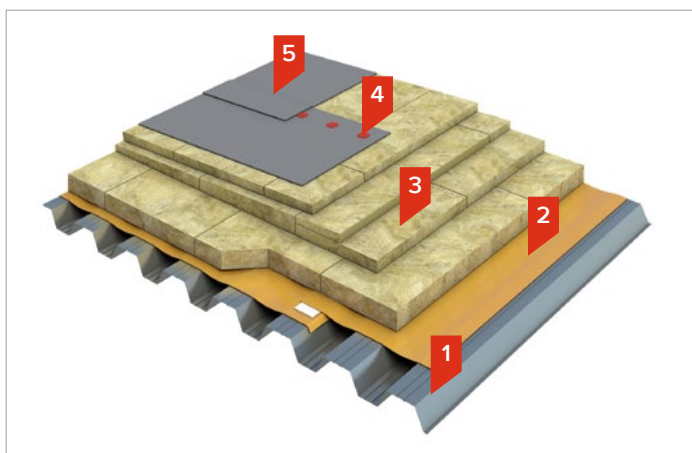

## MECHANICALLY FIXED ROOFING SYSTEM

This system provides the fastest installation under varied weather conditions. It is most popular for non-accessible roofs with large surface areas. It has a high level of resilience to strong wind and movement of the structure.

1. Corrugated steel sheet
2. Vapor barrier VAPORSTOP CA 500
3. TECHNOROOF stone wool insulation boards
4. Mechanical fixation
5. LOGICROOF V-RP, LOGICROOF V-RP T

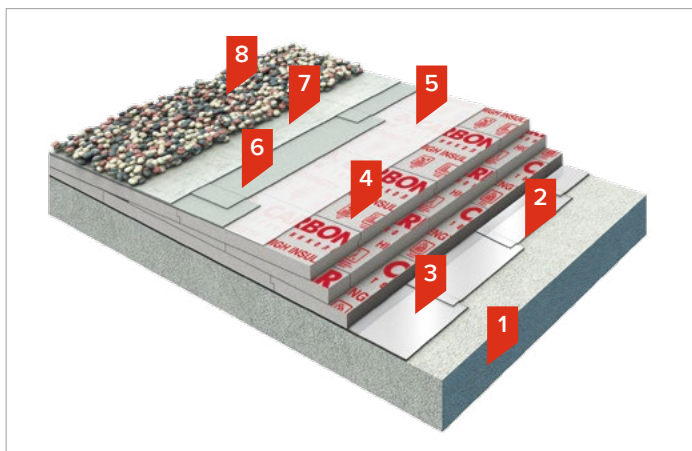

## BALLASTED ROOFING SYSTEM

In this system the membrane is protected against UV radiation and life-loads by an upper layer of ballast or paving slabs. It is used for terraces and accessible roofs.

1. Reinforced concrete
2. BITUMEN PRIME COATING
3. Vapor barrier VAPORSTOP CA 500 or ULTRAFLEX SA 1.5 mm
4. XPS TECHNONICOL CARBON PROF 300
5. Geotextile 300 g/m<sup>2</sup>
6. LOGICROOF V-GR
7. Geotextile > 300 g/m<sup>2</sup>
8. Ballast

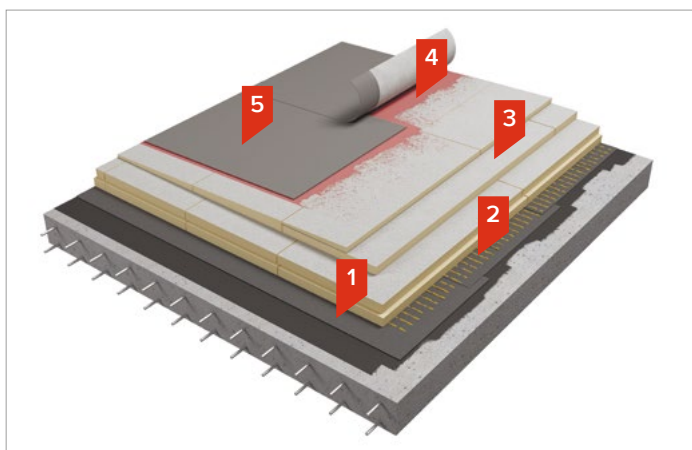

## FULLY ADHERED ROOFING SYSTEM

This special roofing system is used when mechanical fixation of the membrane to a substrate is not possible or the highest resistance against wind upload is required. This is also a practical solution for roofs renovation.

1. Existing roof system
2. Foam LOGICROOF Spray
3. TECHNONICOL PIR thermal insulation boards
4. Adhesive LOGICROOF Spray
5. LOGICROOF V-RP FB

# REFERENCE LIST



Distribution centre Tchibo, Cheb, Czech Republic  
LOGICROOF V-RP 1.5 mm | 65 000 m<sup>2</sup>



Toyota plant, Saint Petersburg, Russia  
LOGICROOF V-RP 1.5 mm | 60 000 m<sup>2</sup>



Hypermarkets OBI, Russia  
LOGICROOF V-RP 1.2 mm | 150 000 m<sup>2</sup>



Olympic Stadium, Moscow, Russia  
LOGICROOF V-RP FB 1.8 mm | 40 000 m<sup>2</sup>



Spartak Moscow stadium, Moscow, Russia  
LOGICROOF V-RP 1.2 mm | 36 000 m<sup>2</sup>



Kurumoch International Airport, Kurumoch, Russia  
LOGICROOF V-RP 1.5 mm | 44 000 m<sup>2</sup>

## TECHNONICOL India Private Limited

### Head Office in Mumbai

102, Joy Villa, Plot No. 58,  
Jawahar Nagar Road No. 4, Goregaon (W),  
Mumbai 400 104  
Ph: +91 22 2872 8691  
info@technicol.in

### Office in New Delhi

Unit No. G-31, ground floor,  
TDI Centre, Jasola District Centre,  
New Delhi 110 025  
Ph: +91 11 4372 1455  
info@technicol.in

